

**PLAN 2-5C**

MAIN DECK

3/32"=1'-0"

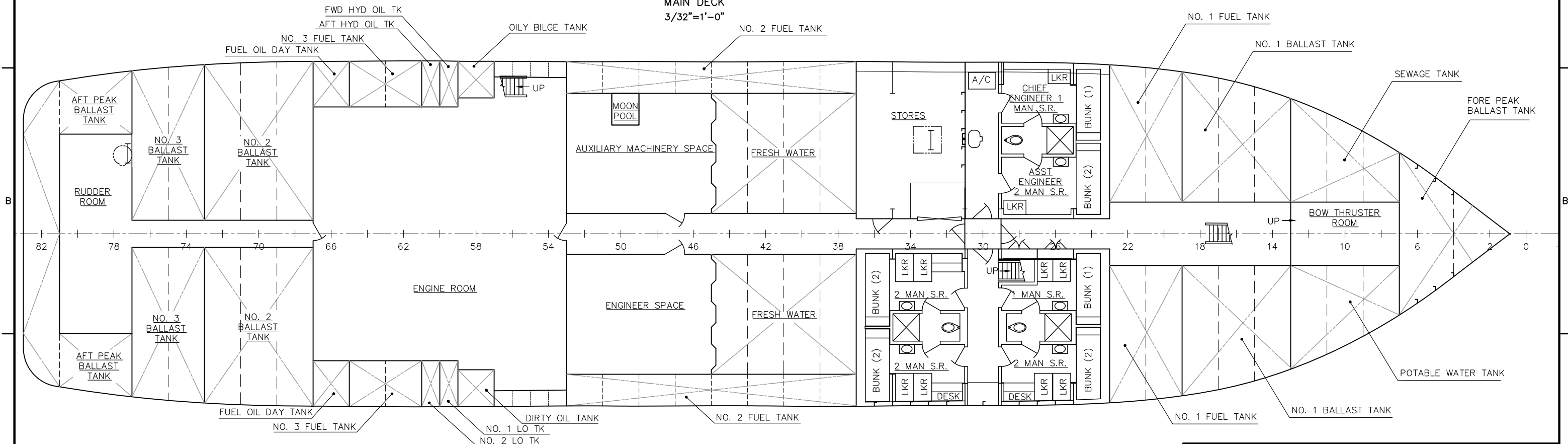

**PLAN 2-5A**

HOLD LEVEL

3/32"=1'-0"

<b>BIOS</b> ST. GEORGE'S, BERMUDA			
<b>R/V ATLANTIC EXPLORER</b> GENERAL ARRANGEMENT HOLD LEVEL AND MAIN DECK PLANS			
<b>THE GLOSTEN ASSOCIATES</b> <i>Consulting Engineers Serving the Marine Community</i>		1201 Western Avenue, Suite 200 Seattle, Washington 98101-2953 TEL: 206.624.7850 WEB: www.glosten.com	
Drawn TGA	Checked CSC	Approved DHK	Date 05/30/2014
Scale AS NOTED	Drawing Number 12146-070-01	Sheet 2 of 4	Revision A