

ELEVATION 1-5A
 OUTBOARD PROFILE
 1-16"=1'-0"

PRINCIPAL DIMENSIONS	
LOA	171'-3"
LBP	162'-0"
MOLDED BREADTH	38'-0"
MOLDED DEPTH	14'-3"
LOAD LINE DRAFT	11'-5 3/8"
LIGHTSHIP	811.19 LT

GENERAL NOTES

- AS-BUILT UPDATES INCORPORATED PER SHIP CHECK CONDUCTED IN 2013. THIS DRAWING REPRESENTS DETAILS VISIBLE AT THE TIME OF SURVEY WITHOUT DISASSEMBLY OF VESSEL STRUCTURE, JOINERY, LININGS, ETC.

REFERENCES

- ELLIOTT BAY DESIGN GROUP DWG NO. 05100-6-1041, R/V ATLANTIC EXPLORER GENERAL ARRANGEMENT, REV. C

REVISIONS

ZONE	REV	DESCRIPTION	DATE	APPD

BIOS
 ST. GEORGE'S, BERMUDA
R/V ATLANTIC EXPLORER
 GENERAL ARRANGEMENT
 OUTBOARD PROFILE

THE GLOSTEN ASSOCIATES
 Consulting Engineers Serving the Marine Community
 1201 Western Avenue, Suite 200
 Seattle, Washington 98101-2953
 TEL 206.624.7850
 WEB www.glosten.com

Drawn TGA	Checked CSC	Approved DHK	Date 05/30/2014
Scale AS NOTED	Drawing Number 12146-070-01	Sheet 1 of 4	Revision A

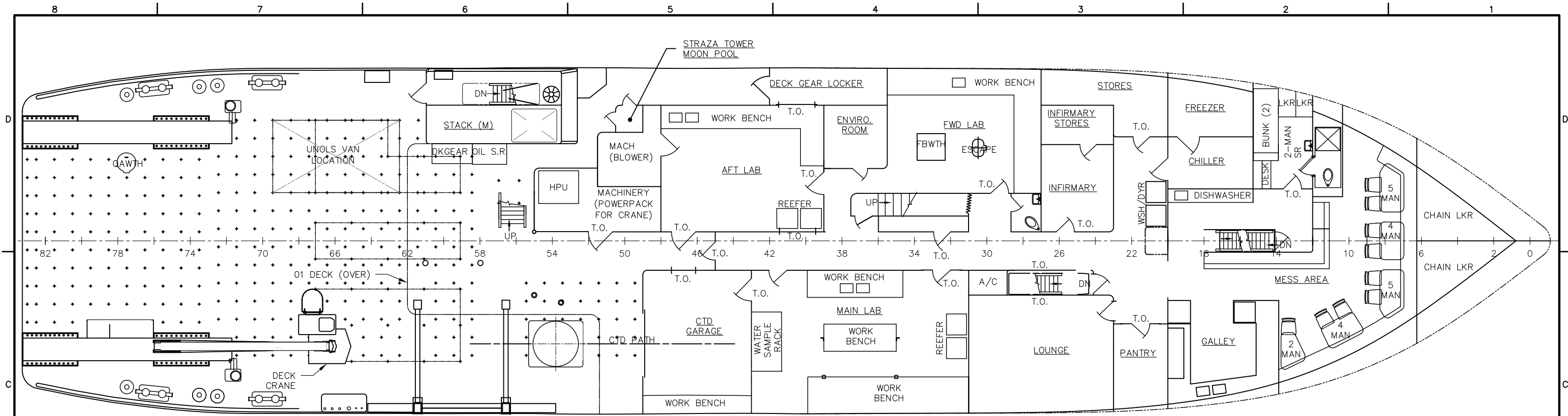

PLAN 2-5C

MAIN DECK

3/32"=1'-0"

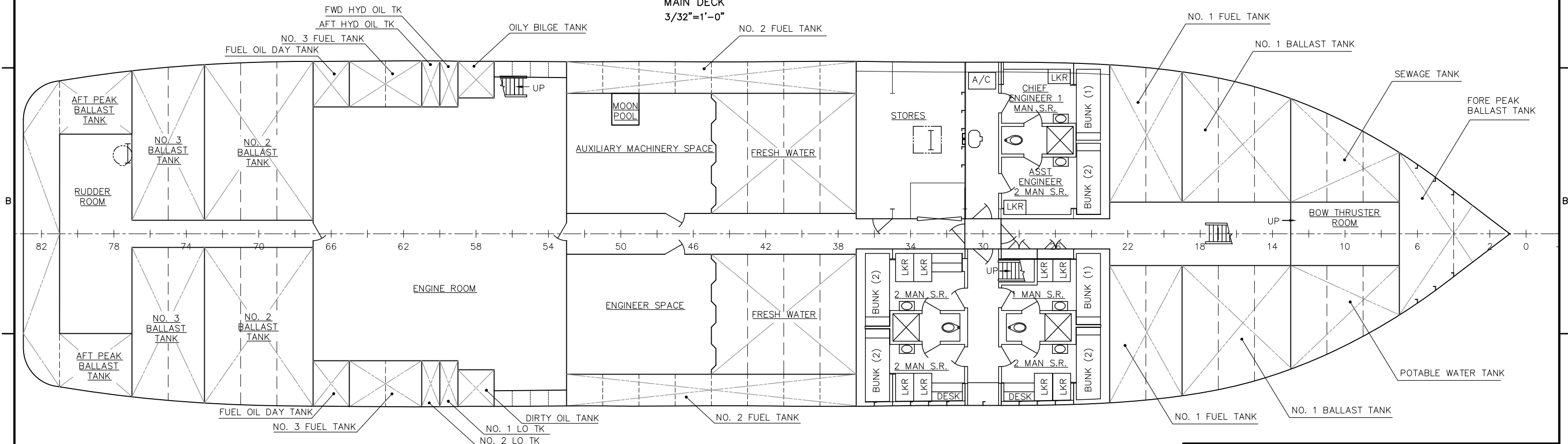

PLAN 2-5A

HOLD LEVEL

3/32"=1'-0"

BIOS ST. GEORGE'S, BERMUDA			
R/V ATLANTIC EXPLORER GENERAL ARRANGEMENT HOLD LEVEL AND MAIN DECK PLANS			
THE GLISTEN ASSOCIATES <i>Consulting Engineers Serving the Marine Community</i>		1201 Western Avenue, Suite 200 Seattle, Washington 98101-2953 TEL: 206.624.7850 WEB: www.glisten.com	
Drawn TGA	Checked CSC	Approved DHK	Date 05/30/2014
Scale AS NOTED	Drawing Number 12146-070-01	Sheet 2	of 4
		Revision A	

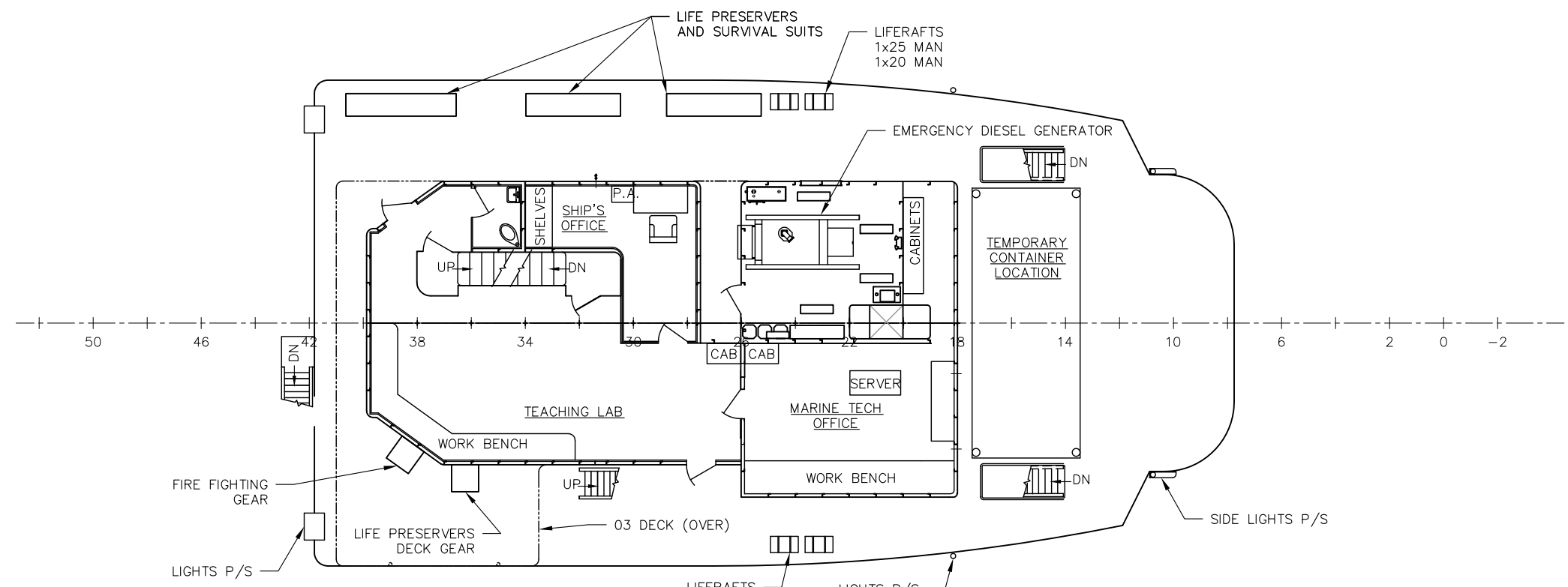

PLAN 3-5C
02 LEVEL
3/32"=1'-0"

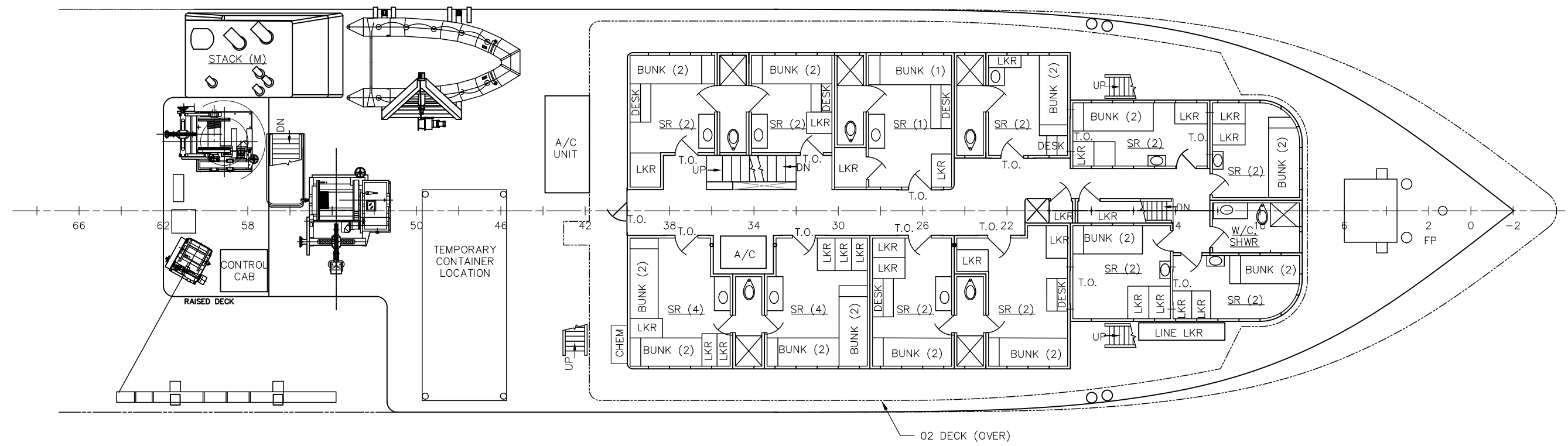

PLAN 3-5A
01 LEVEL
3/32"=1'-0"

BIOS ST. GEORGE'S, BERMUDA			
R/V ATLANTIC EXPLORER GENERAL ARRANGEMENT 01 LEVEL AND 02 LEVEL PLANS			
THE GLOSTEN ASSOCIATES <i>Consulting Engineers Serving the Marine Community</i>		1201 Western Avenue, Suite 200 Seattle, Washington 98101-2953 TEL 206.624.7850 WEB www.glosten.com	
Drawn TGA	Checked CSC	Approved DHK	Date 05/30/2014
Scale AS NOTED	Drawing Number 12146-070-01	Sheet 3	of 4
		Revision A	

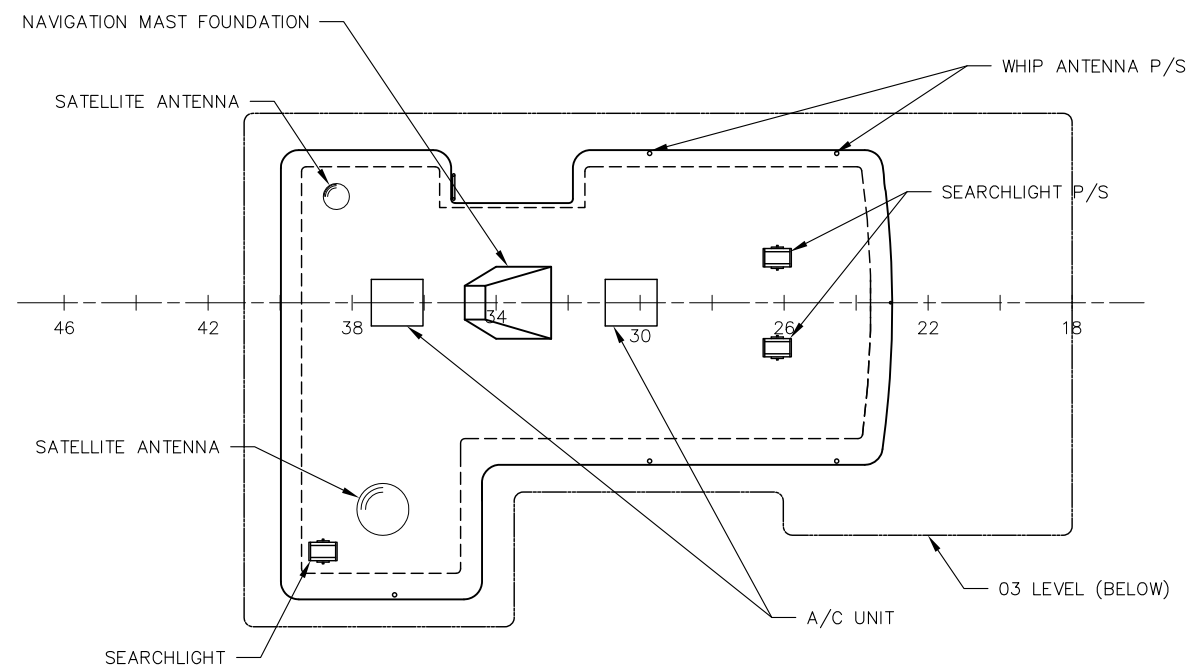

PLAN 4-5C
HOUSE TOP / 04 LEVEL
3/32"=1'-0"

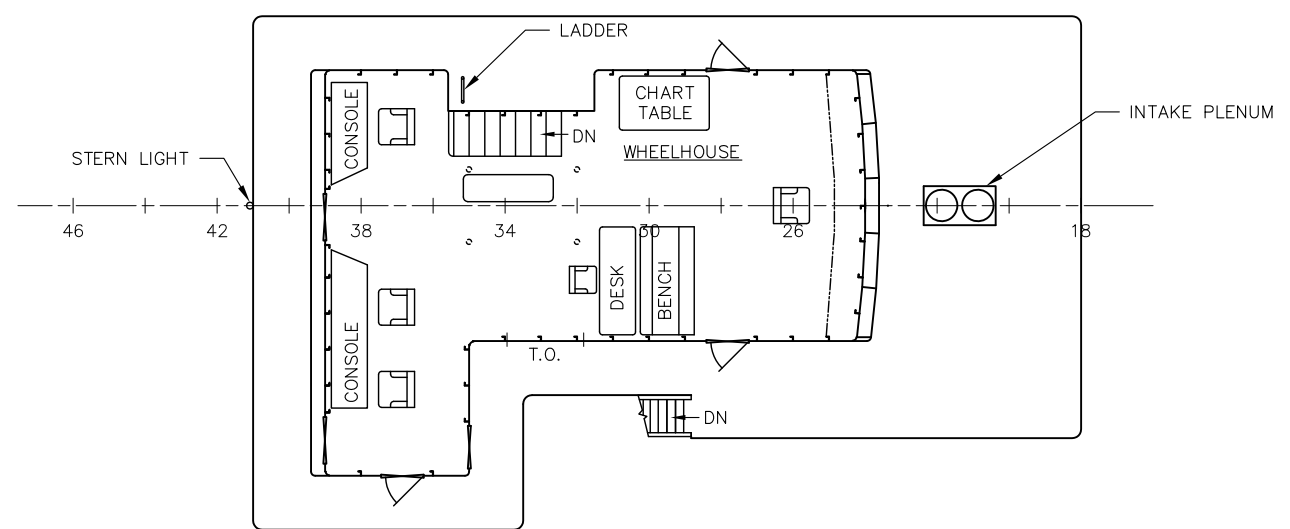

PLAN 4-5A
03 LEVEL
3/32"=1'-0"

BIOS ST. GEORGE'S, BERMUDA			
R/V ATLANTIC EXPLORER GENERAL ARRANGEMENT 03 LEVEL AND 04 LEVEL / HOUSE TOP PLANS			
THE GLOSTEN ASSOCIATES Consulting Engineers Serving the Marine Community		<small>1201 Western Avenue, Suite 200 Seattle, Washington 98101-2953 TEL 206.624.7850 WEB www.glosten.com</small>	
Drawn TGA	Checked CSC	Approved DHK	Date 05/30/2014
Scale AS NOTED	Drawing Number 12146-070-01	Sheet 4	of 4
		Revision A	